

CRUSE
& ASSOCIATES
PROFESSIONAL LAND SURVEYORS

RECEIVED

APR 22 2013

KITTITAS COUNTY
CDS

BACH BLA DESCRIPTIONS
4/17/13

Easterly Parcel

The east 443.98 feet, measured perpendicular to the east boundary thereof, of the following described property:

That portion of the South Half of the Southwest Quarter of Section 20, Township 18 North, Range 19 East, W.M, County of Kittitas, State of Washington, described as follows:

Beginning at the southwest corner of said Section 20; thence North 89°58'07" East along the southerly boundary line of the Southwest Quarter of said Section, a distance of 30.00 feet to the easterly right-of-way boundary line of the County Road known as Wilson Creek Road; thence North 00°16'27" West, along the easterly right-of-way boundary line of said County road a distance of 193.00 feet to the True Point of Beginning, said line being parallel with and 30.00 feet easterly of the westerly boundary line of the Southwest Quarter of said Section and the centerline of said County road; thence continuing North 00°16'27" West along the easterly right-of-way boundary line of said County road a distance of 101.25 feet, said line being parallel with and 30.00 feet easterly of the westerly boundary line of the Southwest Quarter of said Section and the centerline of said County road; thence N 89°58'07" East a distance of 1917.99 feet to the centerline of a creek, name unknown, said line being parallel with the southerly boundary line of the Southwest Quarter of said Section; thence South 01°27'55" East along the centerline of said creek, a distance of 294.34 feet to the southerly boundary line of the South Half of the Southwest Quarter of said Section; thence South 89°58'07" West a distance of 974.61 feet, said point being North 89°58'07" East a distance of 979.50 feet from the southwest corner of the Southwest Quarter of said Section; thence North 00°16'27" West a distance of 253.00 feet, said line being parallel with the westerly boundary line of the Southwest Quarter of said Section; thence South 89°58'07" West a distance of 559.00 feet, said line being parallel with the southerly boundary line of the South Half of the Southwest Quarter of said Section; thence South 00°16'27" East a distance of 60.00 feet, said line being parallel with the westerly boundary line of the Southwest Quarter of said Section; thence South 89°58'07" West a distance of 390.50 feet to the True Point of Beginning, said line being parallel with the southerly boundary line of the South Half of the Southwest Quarter of said Section.

Contains 3.00 acres



CRUSE & ASSOCIATES

PROFESSIONAL LAND SURVEYORS

BACH BLA DESCRIPTIONS (cont.)

4/17/13

Westerly Parcel

That portion of the South Half of the Southwest Quarter of Section 20, Township 18 North, Range 19 East, W.M, County of Kittitas, State of Washington, described as follows:

Beginning at the southwest corner of said Section 20; thence North $89^{\circ}58'07''$ East along the southerly boundary line of the Southwest Quarter of said Section, a distance of 30.00 feet to the easterly right-of-way boundary line of the County Road known as Wilson Creek Road; thence North $00^{\circ}16'27''$ West, along the easterly right-of-way boundary line of said County road a distance of 193.00 feet to the True Point of Beginning, said line being parallel with and 30.00 feet easterly of the westerly boundary line of the Southwest Quarter of said Section and the centerline of said County road; thence continuing North $00^{\circ}16'27''$ West along the easterly right-of-way boundary line of said County road a distance of 101.25 feet, said line being parallel with and 30.00 feet easterly of the westerly boundary line of the Southwest Quarter of said Section and the centerline of said County road; thence N $89^{\circ}58'07''$ East a distance of 1917.99 feet to the centerline of a creek, name unknown, said line being parallel with the southerly boundary line of the Southwest Quarter of said Section; thence South $01^{\circ}27'55''$ East along the centerline of said creek, a distance of 294.34 feet to the southerly boundary line of the South Half of the Southwest Quarter of said Section; thence South $89^{\circ}58'07''$ West a distance of 974.61 feet, said point being North $89^{\circ}58'07''$ East a distance of 979.50 feet from the southwest corner of the Southwest Quarter of said Section; thence North $00^{\circ}16'27''$ West a distance of 253.00 feet, said line being parallel with the westerly boundary line of the Southwest Quarter of said Section; thence South $89^{\circ}58'07''$ West a distance of 559.00 feet, said line being parallel with the southerly boundary line of the South Half of the Southwest Quarter of said Section; thence South $00^{\circ}16'27''$ East a distance of 60.00 feet, said line being parallel with the westerly boundary line of the Southwest Quarter of said Section; thence South $89^{\circ}58'07''$ West a distance of 390.50 feet to the True Point of Beginning, said line being parallel with the southerly boundary line of the South Half of the Southwest Quarter of said Section; EXCEPT the east 443.98 feet, measured perpendicular to the east boundary thereof;

AND

That portion of the Southwest 1/4 of the Southwest 1/4 of Section 20, Township 18 North, Range 19 East, W.M., in the County of Kittitas, State of Washington, described as follows:

Beginning at a point on the South line of Section 20, which is 30 feet East of the Southwest corner thereof, and running North on the East right of way line of the county road 193 feet; thence east, parallel with the Section line, 390.5 feet; thence North 60 feet; thence East, parallel with the section line, 559 feet; thence South 253 feet to a point on the section line; and thence West on the section line 949.5 feet to the point of beginning; EXCEPT that portion thereof lying within the following described parcel:



CRUSE & ASSOCIATES

PROFESSIONAL LAND SURVEYORS

BACH BLA DESCRIPTIONS (cont.)
4/17/13

A tract of land bounded by a line beginning at a point on the south boundary line of said section, 30 feet east of the southwest corner thereof, said point being on the east boundary line of the right of way of the County road; and running thence North $0^{\circ}19'$ West along said East boundary line of the right of way, 332.35 feet; thence South $89^{\circ}55'$ East, 656.3 feet; thence South $0^{\circ}19'$ East, 331.5 feet to the south boundary line of said section; and thence west on said boundary line, 656.3 feet to the point of beginning.

Contains 6.69 acres.

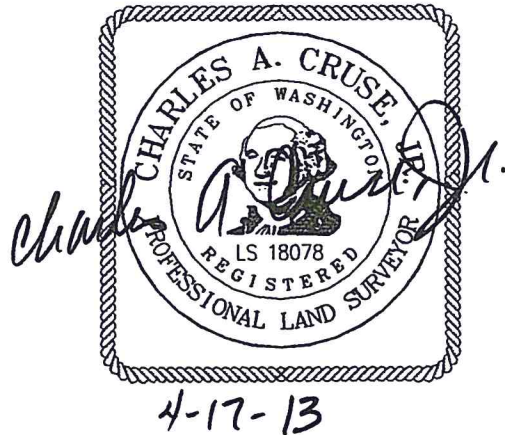

These descriptions are based on information of record.
No field work was performed by Cruse & Associates.

